

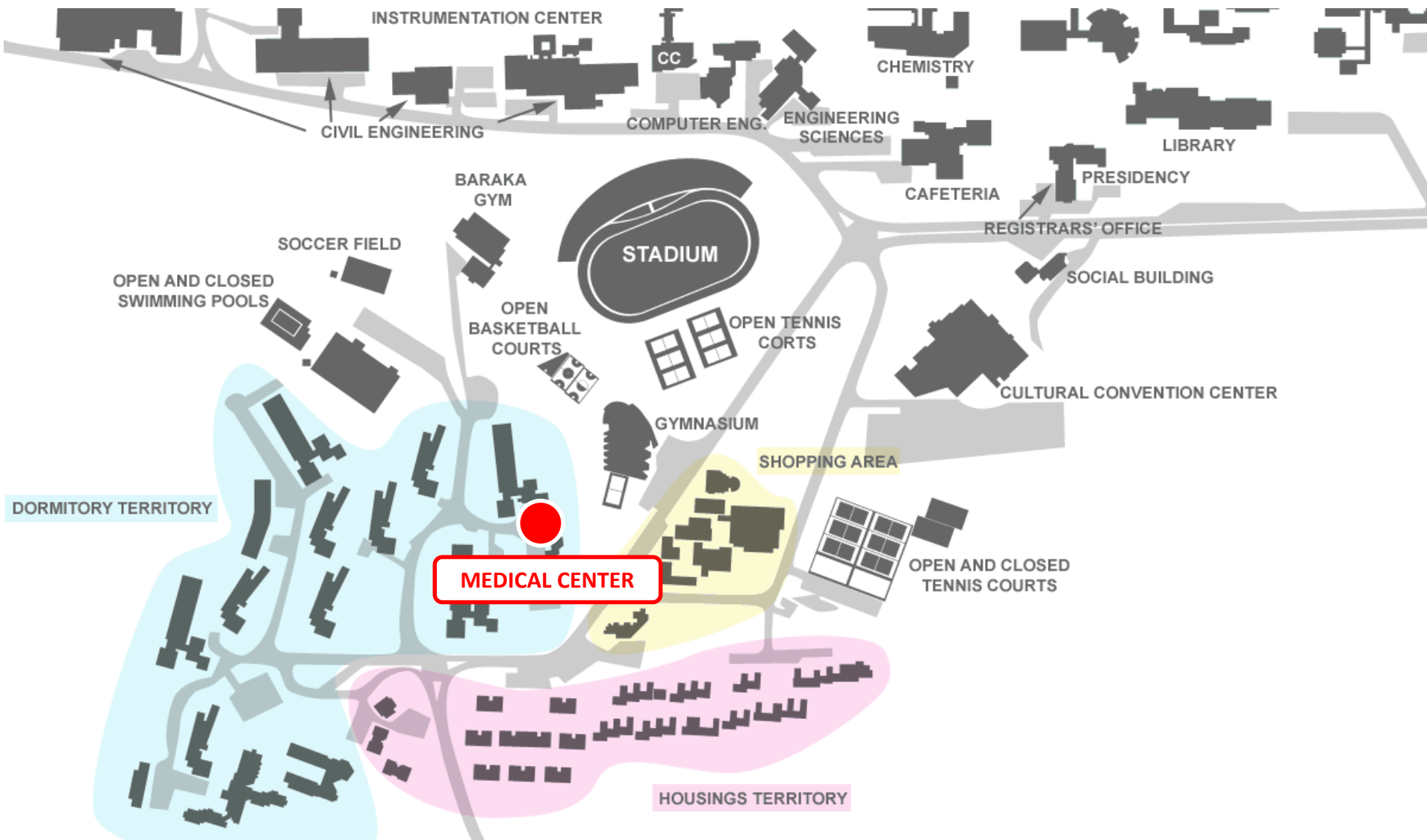

| ODTÜ SAĞLIK VE REHBERLİK MERKEZİ
| METU MEDICAL CENTER

“Using Medical Services at METU”

Where is Medical Center?



Medical Center



ODTÜ SAĞLIK VE REHBERLİK MERKEZİ

METU MEDICAL CENTER

Medical facilities offered at METU consist of

- Medical Center,
- its affiliated laboratory,
- the urgent care unit (first aid) and
- the two psychological counseling and guidance units, one is located at the Preparatory School and the other located next to Mathematics Department.

Medical Center is a fully staffed center which provides both

- emergency services,
- services for minor health problems and
- psychological guidance services.

ODTÜ SAĞLIK VE REHBERLİK MERKEZİ

METU MEDICAL CENTER

- 9 general practitioners, 17 specialist physicians (2 dermatologists, 1 urologist, 1 biochemist, 1 microbiologist, 1 physical therapy and rehabilitation specialist, 2 pediatricians, 2 gynecologists, 1 ear, nose and throat specialist, 1 radiologist, 1 psychiatrist, 1 ophthalmologist, 1 dental surgeon), 4 dentists,
- 15 nurses, 6 lab technicians, 2 x-ray technicians, 3 physiotherapists, 6 clinical psychologist and 4 counselors work in the center.

ODTÜ SAĞLIK VE REHBERLİK MERKEZİ

METU MEDICAL CENTER

- The medical doctors at the center consult their patients from 9:00 to 12:00 and from 13:30 to 16:00 p.m, Monday to Friday.
- For other services hours may change.
- For some services, such as psychological guidance, you should get an appointment.
- Emergency service is available 24 hours a day.

Setting Plan of the Medical Center

A Block 1st Floor

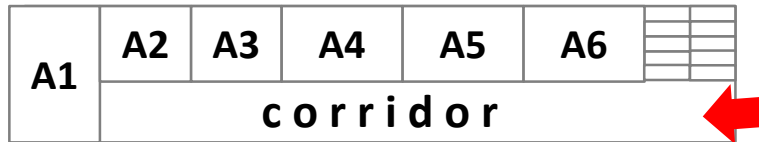

A1 : Gynecology

A2-A6 : General Practitioners

A Block 2nd Floor

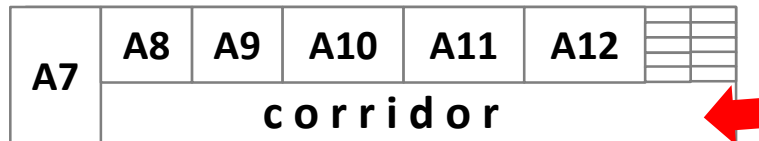

A7-A9 : Pediatrics

A10-A11 : General Practitioners

A12 : Ear nose & throat specialist

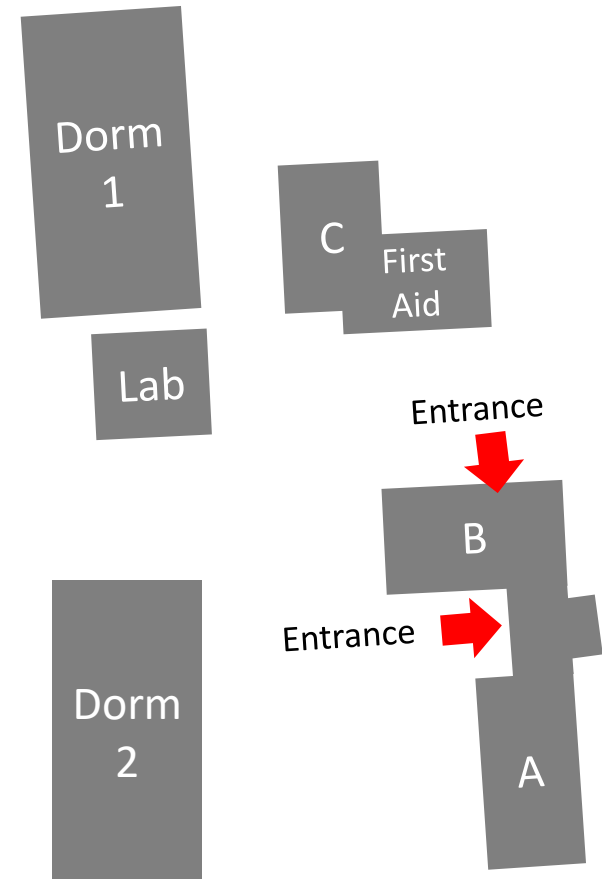

B Block 1st Floor

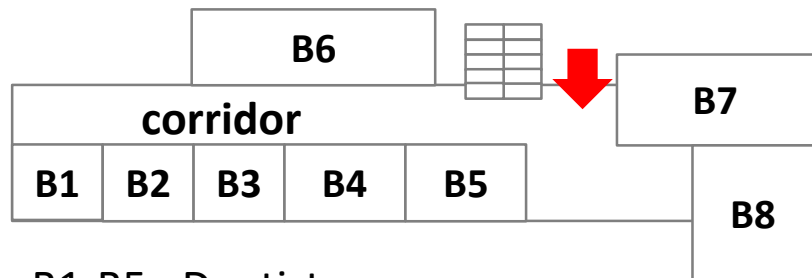

B1-B5 : Dentistry
 B6-B8 : Radiology

B Block 2nd Floor

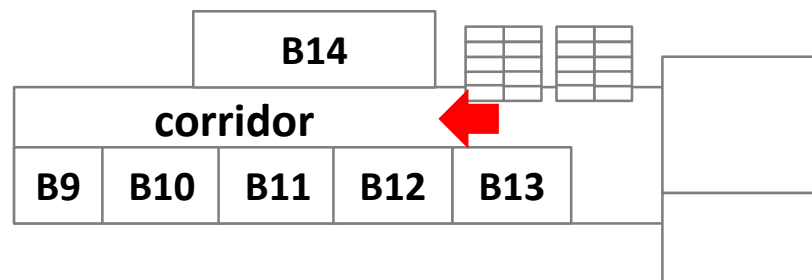

B9 : Urology
 B10 : Eye Diseases
 B11 : General Practitioner
 B12-B13 : Chest Diseases
 B14 : Intervention Room

B Block 3rd Floor

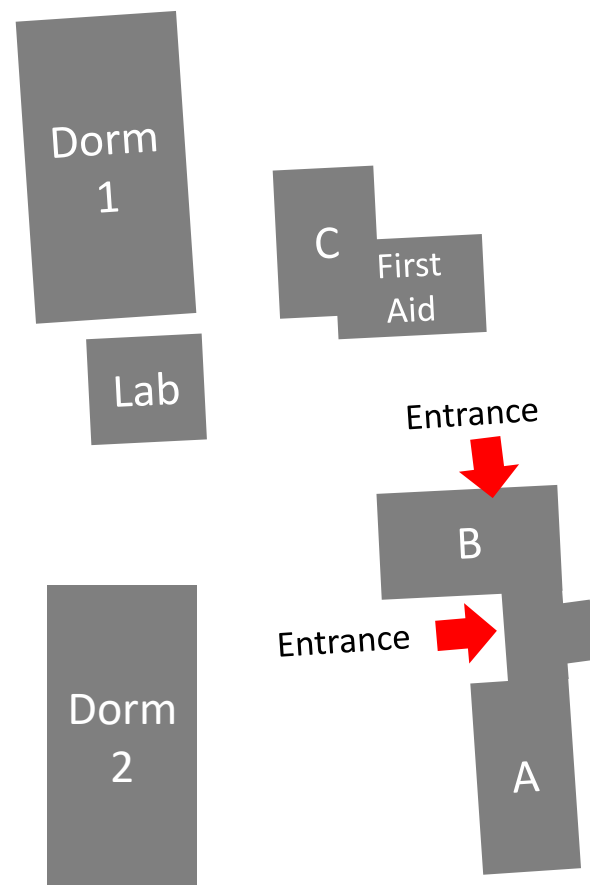
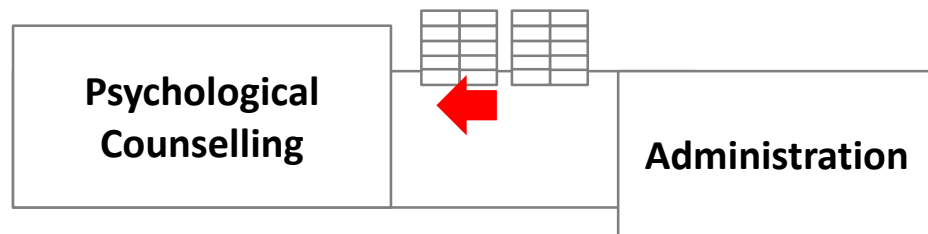

Microbiology & Biochemistry Laboratory

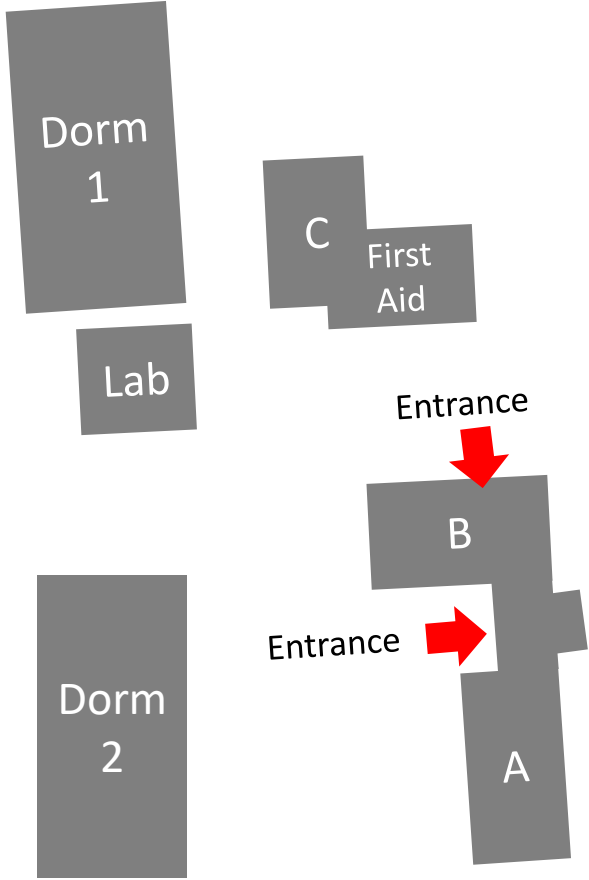
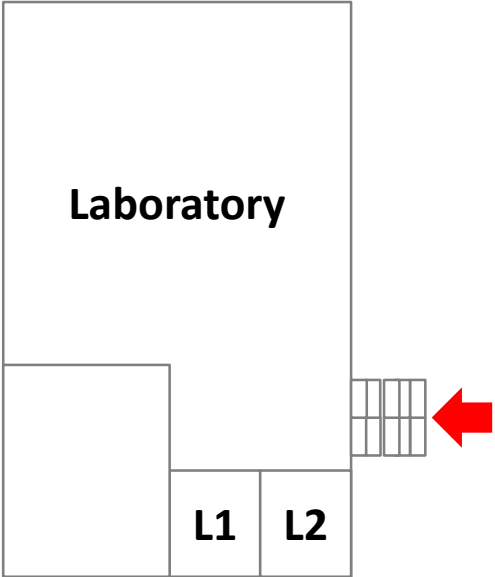

ODTÜ SAĞLIK VE REHBERLİK MERKEZİ

METU MEDICAL CENTER

- Exchange students can apply to Medical Center their health problems. Within the frame of facilities and legislation, examination and treatment of students are conducted in the center.
- In situations requiring further examination and treatment, the student may be directed to another hospital. There are many state and private hospitals around METU and all around the city.

- Exchange students should have a General Health Insurance to use medical services at METU.
- ***You can get more recent and detailed information about health insurance and related issues from Tahakkuk/Accounts Unit located at the C Block, second floor.***

ODTÜ SAĞLIK VE REHBERLİK MERKEZİ

METU MEDICAL CENTER

- Procedures to be followed at the Medical Center

1. In the first step, you should take queue number from one of the kiosks located on the ground floor of the Center with your Student ID Card.

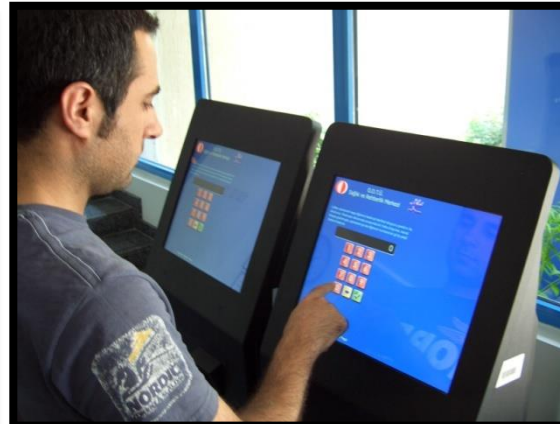
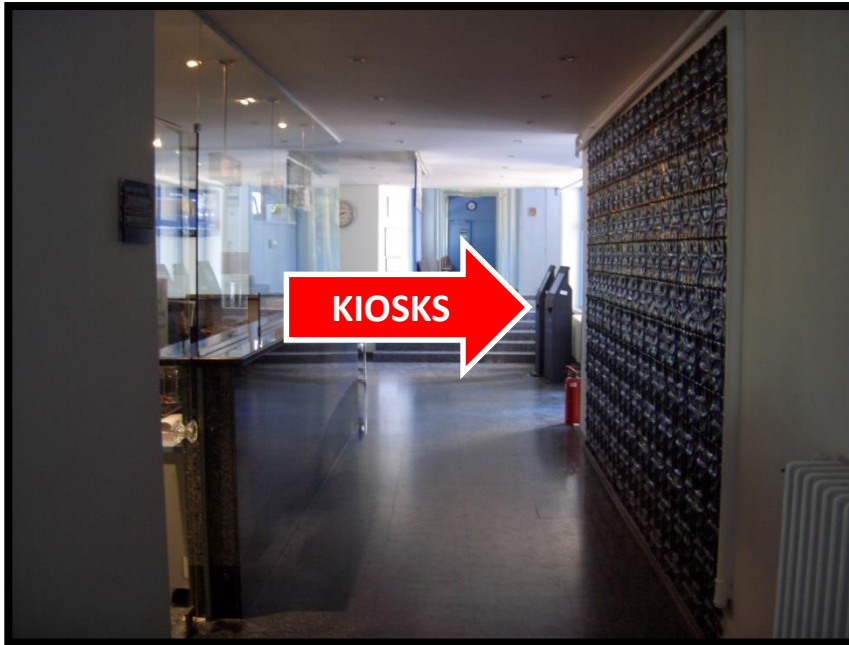

2. You should approach to the Patient Reception desk as soon as your queue number appears on the monitor.



3. A small ticket will be presented to you indicating the name of the doctor and your waiting line number at the Patient Reception desk.

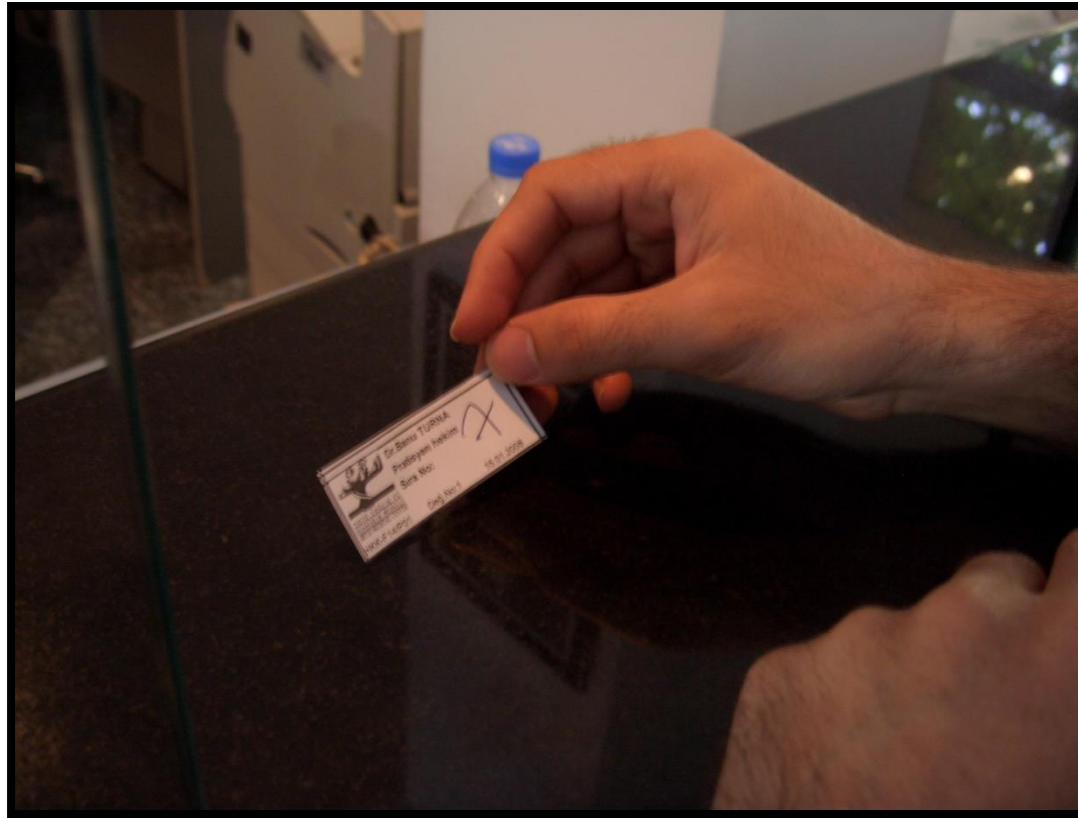

4. You can enter the doctor's office when it is your turn.



5. According to your complaints and needs the doctor will guide you through the medical procedures.



6a. The doctor can request laboratory test online through the EMR (Electronic Medical Records) system. On the next step, you should apply to the Laboratory with your ID number.

The laboratory is located across from the main building of the Medical Center.

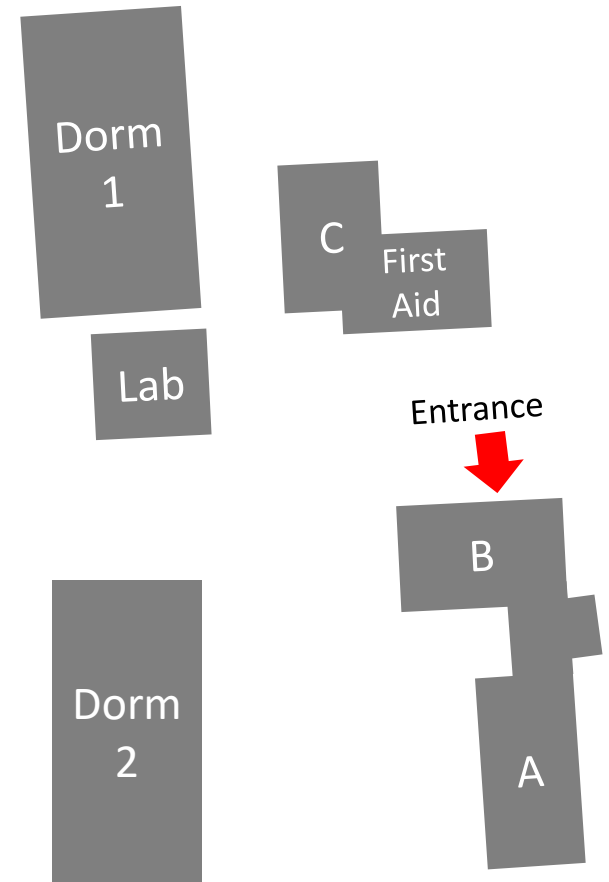

6b. The doctor may request a radiological imaging.
You should apply to the Radiology Unit which is on the
ground floor of B Block with your ID number.

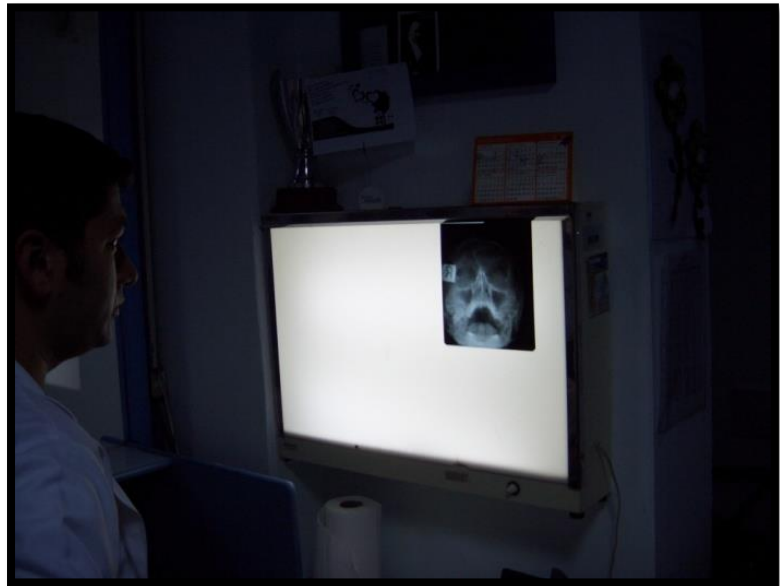

6c. The doctor may request a test (such as electrocardiography, ECG) from First Aid Unit which is on the ground floor of C Block.

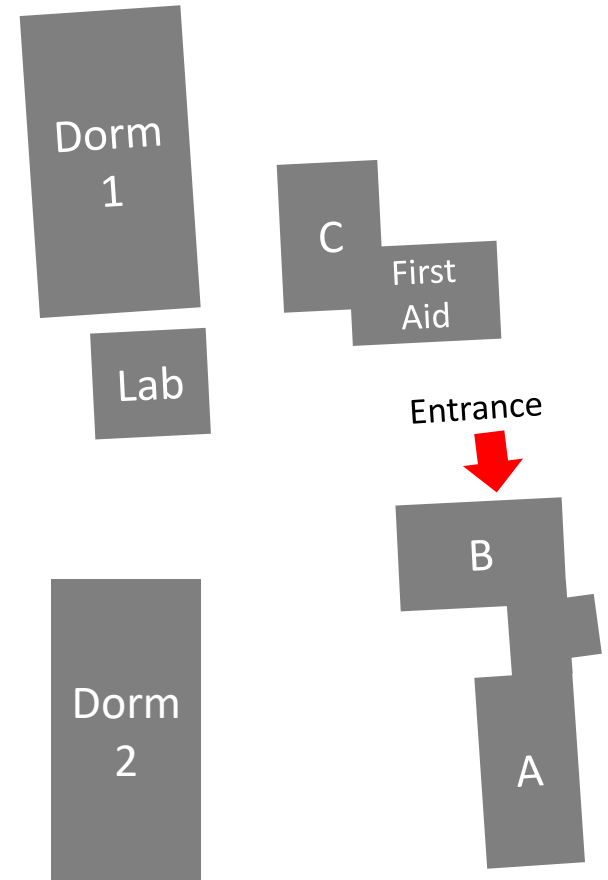

7. The doctor needs your results for the treatment. If you get the results on the same day, you should go to your doctor without any extra procedure. **However, if you get the results a few days later, then you need to apply to the desk and make the officer send your name to doctor via EMR software.**



8. If a prescription is prepared, it will be printed out; signed and handed to you by the doctor. You should take "End Process (Sonlandırma)" number from kiosk to get your prescription stamped and obtain other necessary print outs.

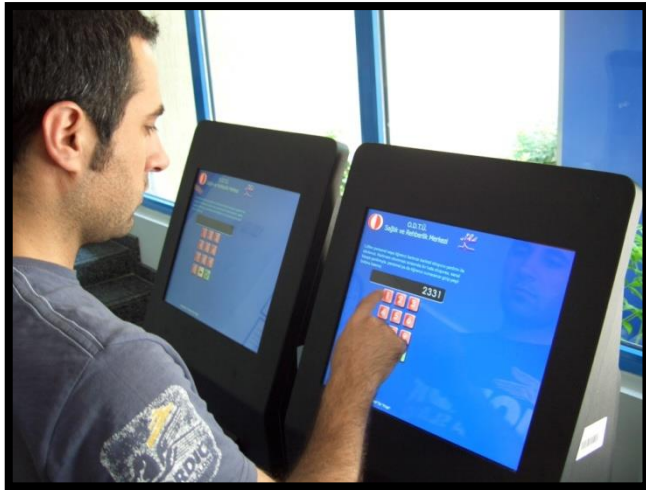

Medical Reports

- Students may miss their classes, exams etc. In order to take make up exams or to finish their incomplete tasks, they should get a medical report. For this medical report to be valid, it must be approved by the Medical Center.
- Medical reports obtained from private doctors' offices are not accepted.
- If students get medical reports from other medical facilities at weekends or in emergency cases when on holiday, they must have their reports approved within three workdays. Otherwise reports are invalid. Apart from official holidays and the periods that the university is closed, medical reports obtained from medical facilities outside Ankara are not approved.

ODTÜ SAĞLIK VE REHBERLİK MERKEZİ
METU MEDICAL CENTER

- Phone: (312) 210 49 68
- Emergency Hotline: (312) 210 49 60
- Ambulance Call Center: (312) 210 41 42
- <http://srm.metu.edu.tr>